

# MotorGuide REPAIR PARTS

**Model:**  
**ZX60V**

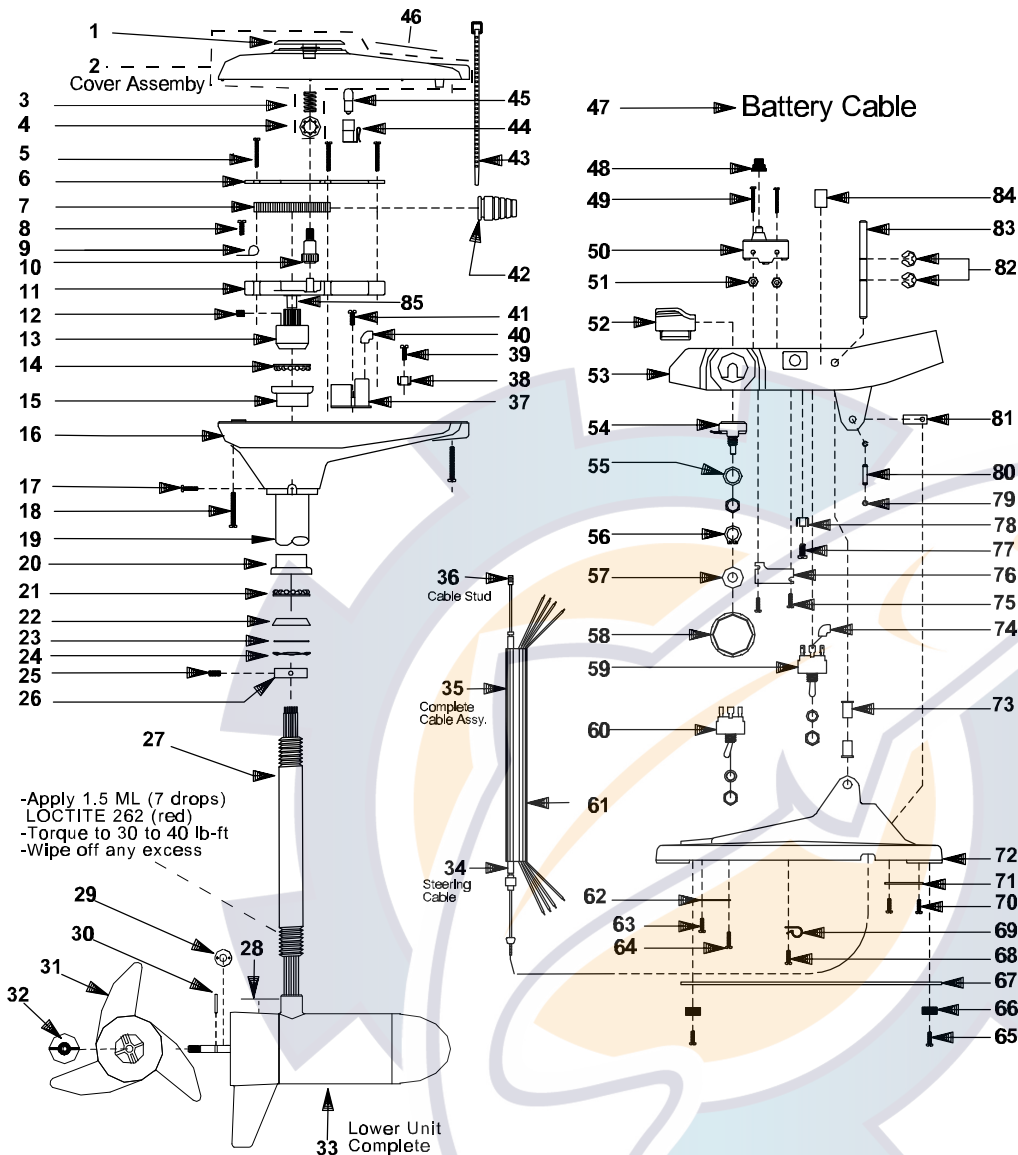

**SPECIFICATIONS:**

Year of Intro	1998
Thrust	62LBS
Volts	24VDC
Amp Draw	0 to 33 amps
Mount	20 Bow
Speeds	Variable

**QUICK REFERENCE PARTS GUIDE:**

Momentary switch	AP151-01
Toggle Switch	FP153-03
DA Board	JF157-02
MOSFET	JF096-08
Motor Seal Kit	6220

**PARTS ORDERING & TECH ASSISTANCE**

MotorGuide Consumer Relations  
Phone 918-831-6989  
Fax 800-982-8093

*Returned Goods must be accompanied with a Returned Goods Authorization. Contact MotorGuide Consumer Relations to obtain RGA.*

KEY	DESCRIPTION	PART #	KEY	DESCRIPTION	PART #	KEY	DESCRIPTION	PART #
1	RED INDICATOR	AF078-08	31	PROP/ 3 BLADE	AF124-10	59	TOGGLE SWITCH 3 POSITIONS	FP153-03
2	TOP HOUSING COVER BLACK	JF053-21	32	PROP NUT	AO999-01	60		
3	COMPRESSION SPRING	AF014-01	33	24V F/O MOTOR WR	UF397-02	61	69" ELECTRIC CABLE JACKET	MM9006-03
4	TINNERMAN CLIP	AF046-01	34	63" CONTROL CABLE STUD ASY	9377	62	63" ELECTRIC CABLE JACKET	MM9006-02
5	#6 RACK GUIDE SCREW	AF133-01	35	69" CONTROL CABLE ASY	9767	63	CABLE PLATE	KP123-01
6	RACK GUIDE COVER	AF127-01	36	69" CONTROL CABLE ASY	AP327-16	64	#6 SELF TAP SCREW	EK135-01
7	RACK	AP125-01	37	CONTROL CABLE STUD	AP327-18	65	6 X 1/2 SCREW	AF135-01
8	#10 x 1/2" SCREW	GR133-01	38	24 VOLT DURA AMP BOARD	AF141-01	66	6 X 1/2 SCREW	AF135-01
9	CABLE CLAMP	AP036-01	39	TERMINAL ( 4 PRONG)	JF157-02	67	FOOT PEDAL PAD	KP023-01
10	INDICATOR GEAR	AF069-01	40	#10 x 1/2" SCREW	FT160-03	68	WEIGHT PLATE ASY	LP3123-01
11	RACK GUIDE	AF126-01	41	INSULATING SLEEVE	GR133-01	69	6 X 1/2 SCREW	AF135-01
12	1/4 NUT SET SCREW	AF142-01	42	GROMMET	AT080-01	70	CABLE CLAMP	KP036-01
13	PM PINION NUT	AF398-02	43	SELF TAPPING SCREW	AF141-01	71	SCREW	IR133-01
14	BEARING	FM005-01	44	LAMP HOLDER	AP071-01	72	BATTERY CLAMP	KP036-02
15	BEARING CUP	AF007-01	45	LAMP	AF030-01	73	FOOT PEDAL BASE	LP003-01
16	T/H BASE BLACK	AF004-07	46	NOMENCLATURE	AF394-01	74	SHAFT BUSHING	KP021-01
17	#6 SELF TAP SCREW	EK135-01	47	BATTERY CABLE ASY W PLUG	AF093-02	75	INSULATING SLEEVE	AT080-01
18	SCREW #8 X 3/4	LF141-03	48	MICRO SWITCH BOOT	JF056-14	76	6 X 1/2 SCREW	AF135-01
19	42/50" OUTER TUBE	AF165-06	49	#6 32 X 1 1/2 SCREW	LP328-05	77	RETAINER PLATE	LP123-03
20	BEARING CUP	FM007-01	50	MICRO SWITCH	KP157-01	78	#10X1/2 SCREW	GR133-01
21	BEARING	FM005-01	51	6 - 32 NUT S.S	LP135-01	79	TERMINAL 4 PRONG	FT160-03
22	BEARING RACE	AF006-03	52	MICRO BUTTON	AP151-01	80	E RING	FP046-01
23	O RING	AF063-01	53	FOOT PEDAL	SP098-02	81	CABLE PIVOT PIN	AP105-01
24	WAVE SPRING WASHER	AF171-01	54	POTENTIOMETER	LP026-01	82	CABLE PIVOT	LP091-01
25	CONE SET SCREW	AF143-01	55	LOCK WASHER 3/8	LP101-03	83	.312 E RING	BK046-02
26	BEARING COLLAR	XF006-01	56	GRIP RING	AP168-02	84	FOOT PEDAL ROCKER PIN	LP102-01
27	42" .105 SS F/O COLUMN	AF049-09	57	NYLON WASHER	KP171-01	85	HI BYPASS DECAL	LP057-03
28	LOWER UNIT DECAL	ET060-04	58	VARIABLE SPEED KNOB	LP046-01		PINION NUT BUSHING	AF021-01
29	MONOFILAMENT WASHER	AR175-01			AK171-02			
30	PROP DRIVE PIN	BR102-01			LP082-06			

LOWER UNIT BREAKDOWN

Model:  
**ZX60V**

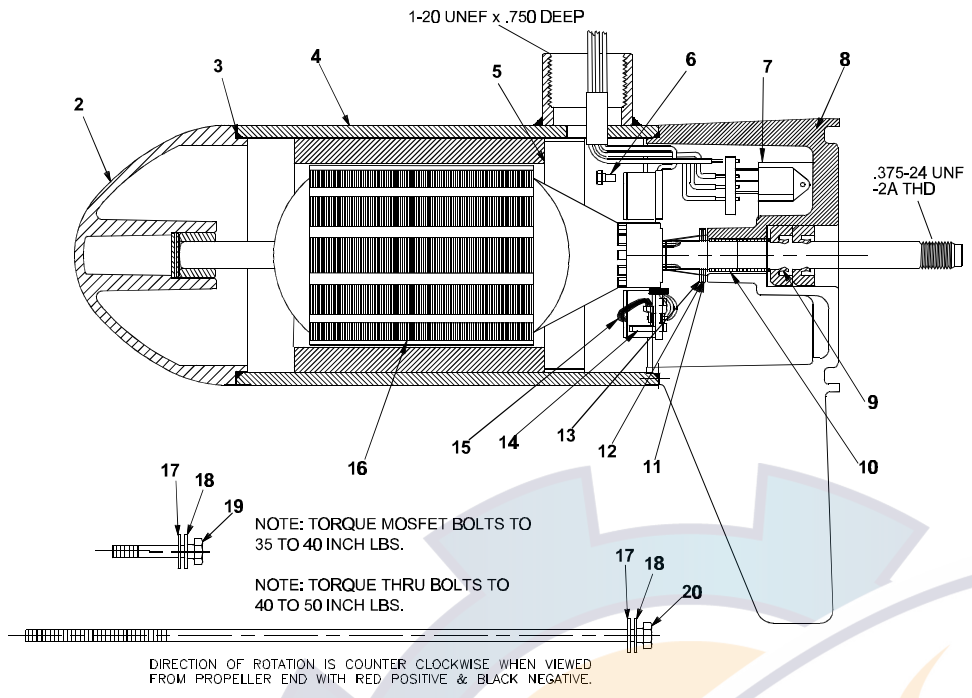

WIRING

SUBJECT TO DAMAGE BY STATIC ELECTRICITY  
ASSEMBLE AT STATIC FREE WORK STATION!

